

MELGRAND.

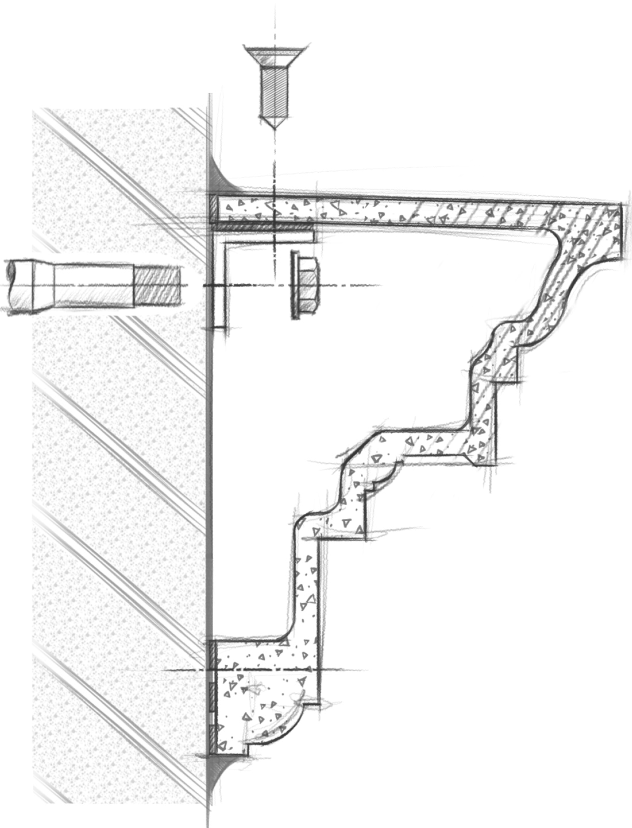

GRC (Glass Reinforced Concrete) Moulds Installation Guide



GRC MOULDS INSTALLATION GUIDE

GRC mouldings can be produced for the following applications:

- Architraves
- Stringers
- Parapets
- Curved architraves
- Curved parapets
- Keystones and corbels
- Wall vents

All the above mouldings can be fixed to the following substrates; pre-cast concrete, blockwork, brick and render and Harditex base sheet. (When fixing to Harditex base sheet ensure noggins are installed behind mould joints for secure fixing).

GRC Architrave and Stringer Mouldings

GRC architrave and stringer mouldings are to be drilled and then mechanically fixed and glued to the substrate masonry anchor and polyurethane sealant/adhesive (hammer drill must not be used when drilling through GRC mouldings).

When fixing to Harditex base sheet substrate the GRC moulding is to be screwed through the Harditex into subframe, either steel or timber.

GRC mouldings can be cut with a diamond cutting disc fixed to a compound drop saw or angle grinder.

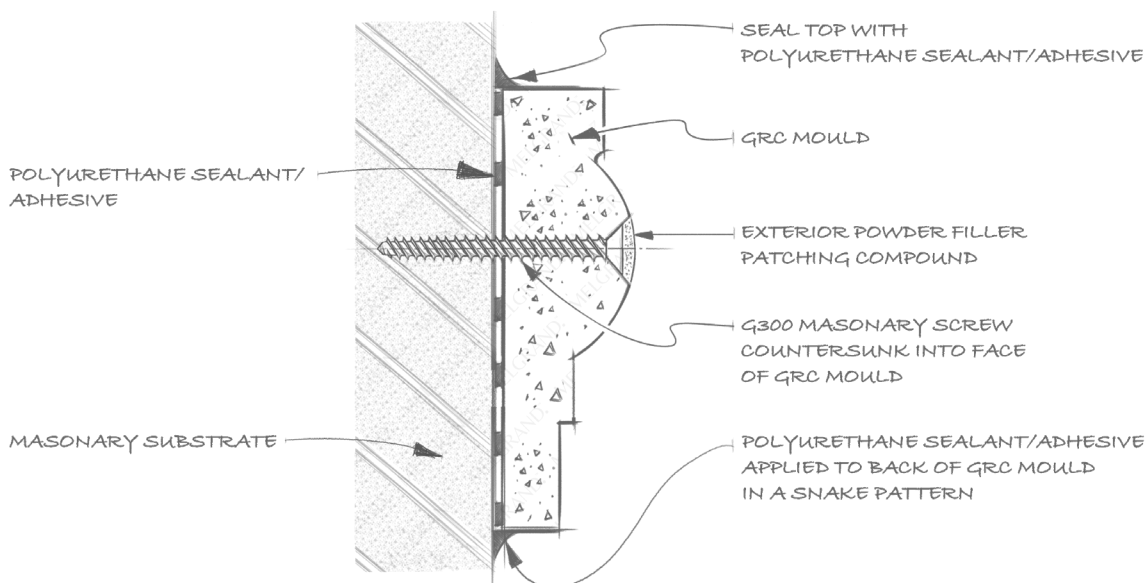

FIXING DETAIL FOR SOLID GRC MOULD

GRC MOULDS INSTALLATION GUIDE

Substrate Surface Preparation

Make sure the substrate is true and level prior to installing the GRC mouldings. Should the substrate be uneven, install suitable packers at the low points to make true the substrate.

When GRC moulding is installed into a true and level substrate, it eliminates undue stress that can result in cracking of the moulding at a later day with daily and seasonal thermal expansion and contraction.

Positioning and Fixing

Prior to installing the GRC moulding, mark the wall with a chalk line to achieve a level datum line and install temporary nails or support timber along the chalk line, so as to allow the moulding to sit in position, whilst being drill fixed into the substrate.

When fixing GRC moulding, drill through the moulding and into the substrate with masonry drill, to suit the size of the selected masonry anchor. Then drill a larger hole far enough into the GRC mould, so as to counter sink the head on the masonry anchor (at least 3mm below moulding surface, hammer drill must not be used when drilling through GRC mouldings).

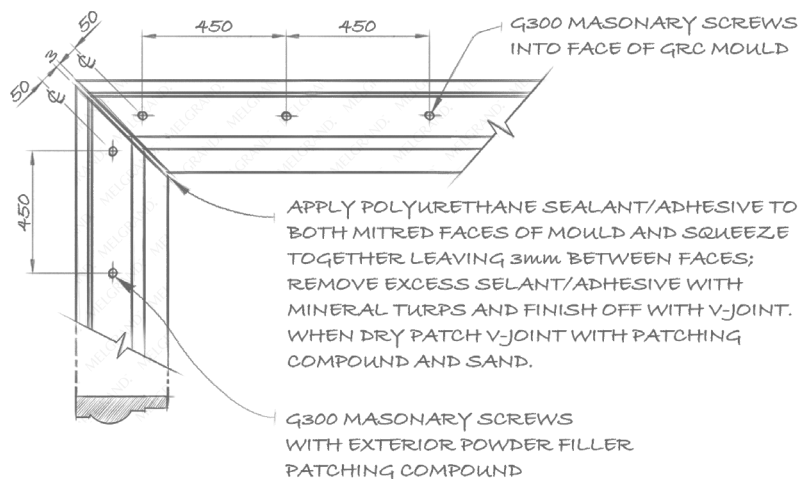

FIXING DETAIL FOR SOLID GRC MOULD

Prior to placing moulding into position onto substrate apply a thick "snake pattern" bead of polyurethane sealant / adhesive onto the back of the GRC mould and fix to wall.

The selected G300 masonry screw is then inserted through the moulding into the substrate and then slowly screwed into position with care not to damage the face of the moulding. Do not over tension the masonry screw fixing.

GRC MOULDS INSTALLATION GUIDE

Fixings are to be installed within 50mm of each end of the moulding, then staggered fixings are to be installed one edge to the other edge of the moulding at 450mm centres along the length of the moulding.

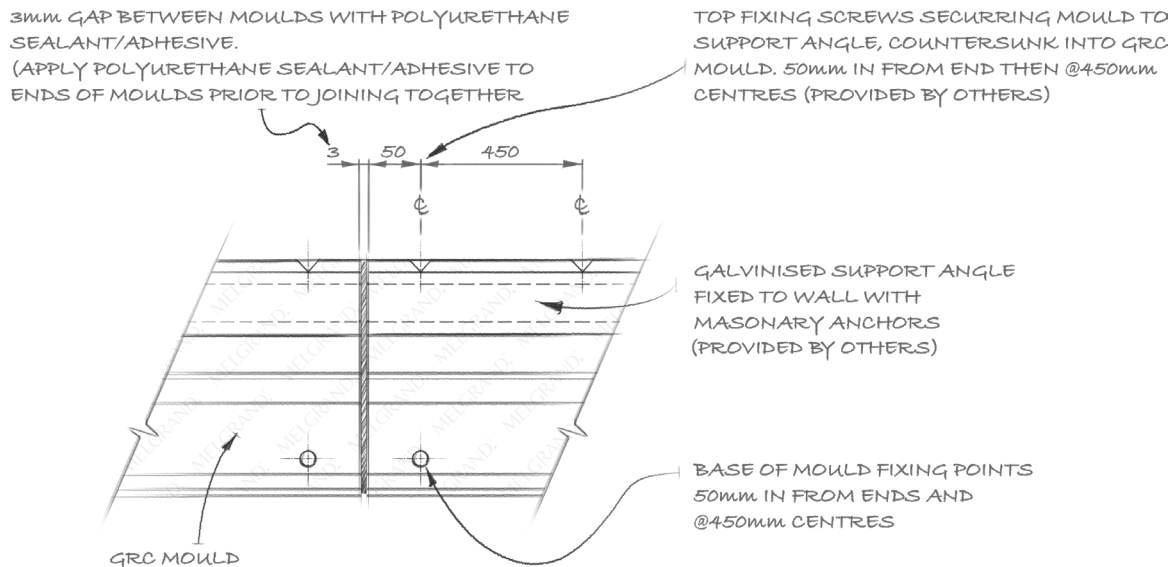

FIXING DETAIL FOR HOLLOW GRC PARAPET MOULD

The above fixing specification relates to standard mouldings. Please check for the preferred fixing method of non-standard mouldings. Counter sunk fixings can be filled with exterior powder filler and smoothed off with a broad knife to achieve a smooth surface finish, then sanded when dry.

After the full length of moulding is fixed into position, both side edges must be sealed between the moulding and the substrate with polyurethane sealant/adhesive (acrylic base/water based gap filler mastics are not to be used).

Joins in the mouldings are to have a 3 mm straight cut, gap filled and surface level clean, with the polyurethane sealants/adhesive, leaving a fine visible pencil line joint.

Upon completion of GRC mouldings installation the complete exposed surface of the moulding is to be painted with one coat of masonry primer in readiness for the final paint colour of your choice.

As GRC mouldings have sharp, clean straight lines in profile, it is not recommended to overcoat the moulding with render of texture.

GRC MOULDS INSTALLATION GUIDE

GRC Parapet Moulds

The fixing into these mouldings is similar to the architrave moulding. The difference being that in a large parapet style moulding installation; a secondary support bracket system (either steel or timber) is to be mechanically fixed to the substrate. The GRC moulding is then installed and mechanically fixed onto the support bracket from the top with secondary screw fixings installed through the face of the GRC into the galvanised support angle (refer to attached sketch). Fixings are to be installed 50mm in from each end and 450mm centres.

A primary masonry screw (G300) is then installed @450mm centres through the lower face of the GRC mould. The countersunk screw is then patched with exterior powder filler patching compound.

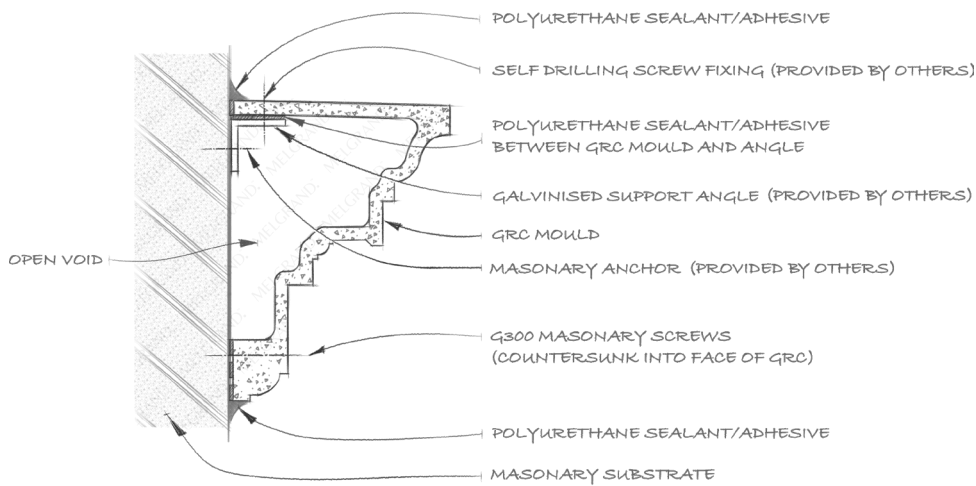

G.R.C. MOULD FIXING DETAIL (SUPPORT ANGLE)

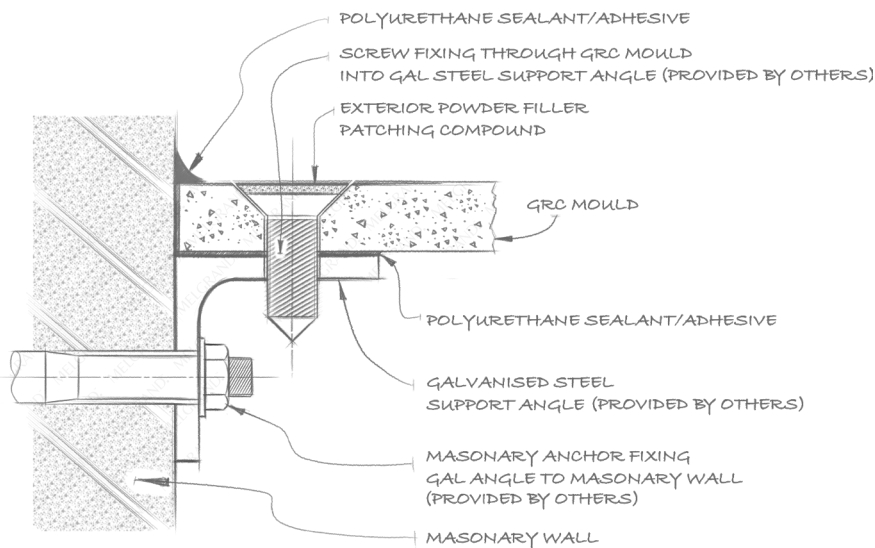

SUPPORT ANGLE FIXING DETAIL FOR HOLLOW G.R.C. PARAPET MOULD

GRC MOULDS INSTALLATION GUIDE

A double row of fixings is required for larger GRC parapet mouldings one into the galvanised steel angle and one into the lower face of the GRC mould into the substrate.

Prior to placing GRC moulding onto support bracket a thick bead of polyurethane sealant/adhesive must be applied to top of bracket and to the bottom abutting edge of GRC moulding.

At all GRC moulding joints, polyurethane sealant/adhesive must be applied to both abutting surfaces and then squeezed together leaving 3mm between mould faces. Excess sealant can be removed with mineral turps. Where GRC mouldings are to be fixed to face brickwork, the brickwork must be cleaned prior to installation and it is recommended to render or bag the brick around the window reveal, so as to blend in with the window architrave.

Note: GRC mouldings must be fully cured prior to installation. When using timber as a support bracket, the recommended timber is kiln dried treated pine.

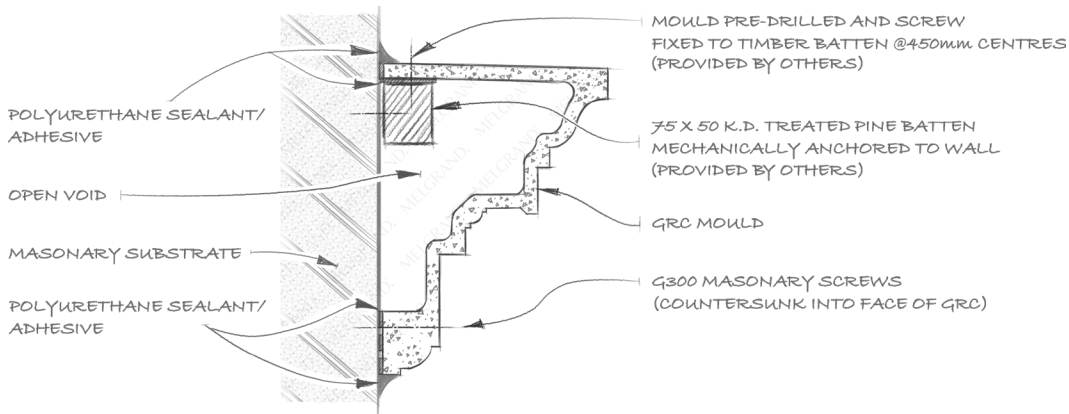

G.R.C. MOULD FIXING DETAIL (TIMBER BATTEN)

WARRANTY

MELGRAND does warrant GRC (Glass Reinforced Concrete) mouldings are free from defects caused by faulty manufacture or materials. If any of the MELGRAND profiles are so defective, MELGRAND will as an option either replace them or reimburse the purchaser for the purchase price.

The fixing methods recommended in this literature are formulated along the lines of good building practice and are intended to assist experienced tradesman in construction procedures. However, this literature is not intended to be an exhaustive statement of all relevant data as the successful installation of the MELGRAND system depends on numerous factors outside the control of MELGRAND eg. quality of workmanship, particular design requirement etc. The company accepts no responsibility for or in connection with the quality of moulding installation or their suitability for any purpose when installed. This warranty excludes all other warranties and liability for damage or loss in connection with defects in MELGRAND products, other than those compulsorily imposed by legislation, notable the Trade Practices Act.



MELGRAND.

FINE ARCHITECTURAL PRODUCTS

melgrand.com.au



ADDRESS

VIC 6-8 Anderson Road, Thornbury 3071
NSW 6/376 Newbridge Rd, Moorebank 2170

CONTACT

1300 663 118
Fax 1300 676 233
sales@melgrand.com.au